

# Blue Tongue™ Modular Aluminium Grid

**Armstrong®**  
CEILING SOLUTIONS



BLUE TONGUE

# Suspension Systems Content

Modular Ceiling Systems ..... Pages 4 – 5

Axiom Perimeter Solutions ..... Page 6

Axiom Pelmet Systems ..... Pages 7 – 8





# Blue Tongue™ Aluminium Grid

## Armstrong® Blue Tongue™ Aluminium Grid Systems

Extruded aluminium grid systems are the natural complement to Armstrong acoustic ceiling panels in A-Grade commercial applications.

Armstrong Ceilings delivers more than 30 years of expertise in ceiling grid solutions to the Australian and New Zealand markets.

We offer a complete range of Modular, One Way and Two Way Systems, for both Mineral Fibre and Metal ceiling panels.

### Key Features

- Full and rapid demountability and re-use of components
- Complete range of interlocking accessories
- Choice of module sizes, including 1200x1200, 1350x1350 and 1500x1500
- Engineered and tested system
- Complete integration with Perimeter/ Pelmet Systems

### Technical Features

- Produced from proven 6063 T5 grade extruded aluminium
- Polyester Powdercoat
- Compliant to AS/NZS 2785:2020 – Suspended Ceiling Code

### Axiom Perimeter Solutions

Armstrong Ceilings provides a comprehensive range of Axiom Perimeter Solutions, including: wall angles, transitions trims and pelmets.

### Custom Ceiling Solutions

Armstrong Ceilings has the capacity of developing custom solutions to suit most commercial requirements.

**For Seismic Design support please contact your local Armstrong Ceilings office.**



Clean mitred cross runner intersection.

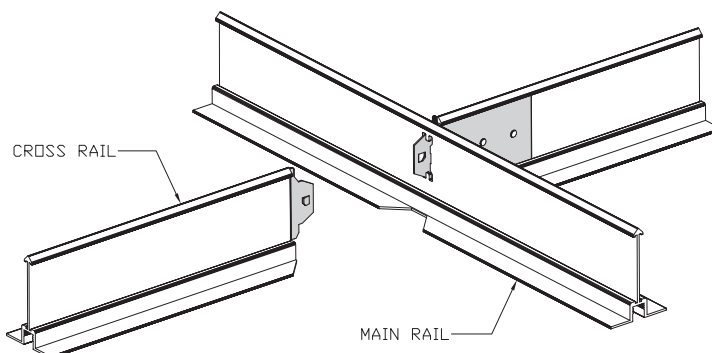

Armstrong® Blue Tongue™ positive lock connection.



3-sided Pelmet with Air Diffuser Face Plate

# Modular Ceiling Systems

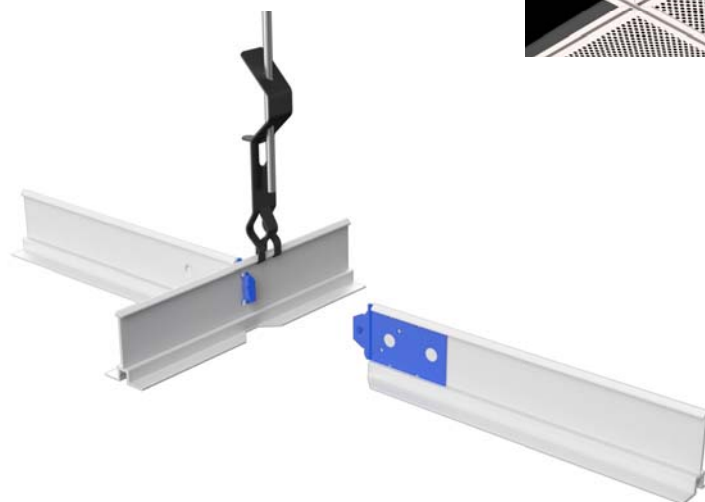

## Component Specifications

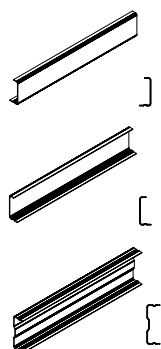
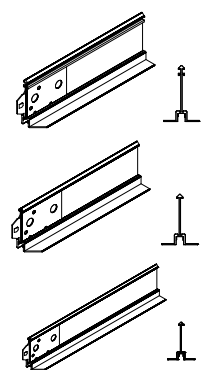
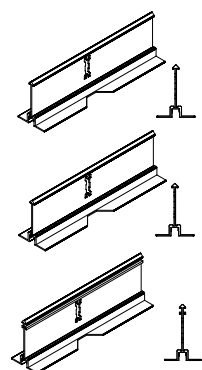

Item	Description	Dimensions (mm)			
		Slot Spacing	Length	Height	Width
Module 1200x1200mm	Top Hat Main Bar	1200	3600	45	32
ALMRTH3600					
ALCRTH1200					
ALCRTH1200	Top Hat Cross Runner	–	1200	45	32
BP743054CA	C-Spline (For Mineral Fibre only)	–	1188	35	10
Module 1350x1350mm	Top Hat Main Bar	1350	4050	45	32
ALMRTH4050					
ALCRTH1350					
ALCRTH1350	Top Hat Cross Runner	–	1350	45	32
BP743354CA	C-Spline (For Mineral Fibre only)	–	1338	35	10
Module 1500x1500mm	Top Hat Main Bar	1500	4500	50	32
ALMRTH4500					
ALCRTH1500					
ALCRTH1500	Top Hat Cross Runner	–	1500	50	32
BP743654CA	C-Spline (For Mineral Fibre only)	–	1488	35	10

# Modular Ceiling Systems

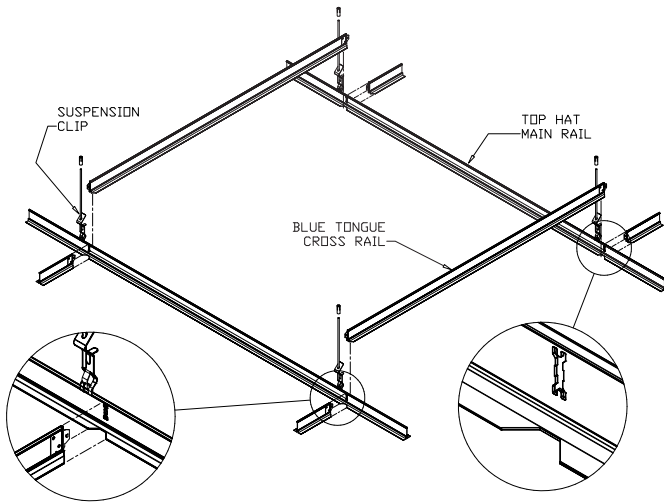
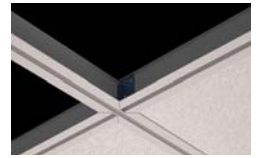

The High tensile "Blue Tongue" staked on clip – provides positive lock connection with ease of installation and demountability.

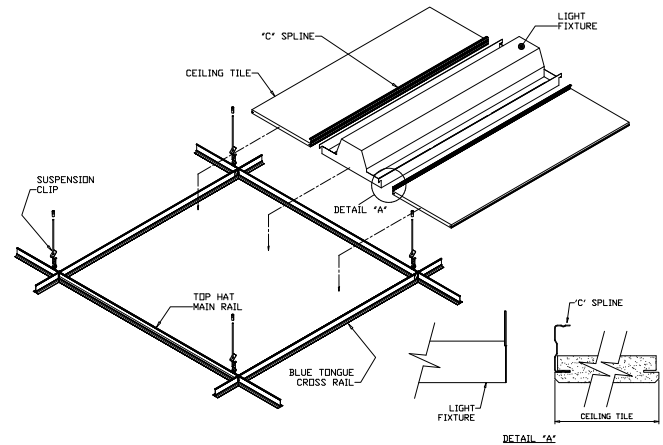

Completed grid system with panels / lights to be installed.

Note: When light fixtures are rotated 90 degrees, an additional suspension hanger is required at the mid point of each cross runner in the module. C-Splines are used only with mineral fibre panels.

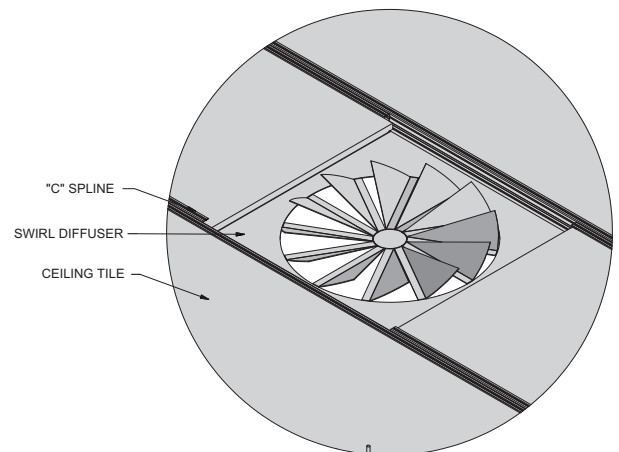
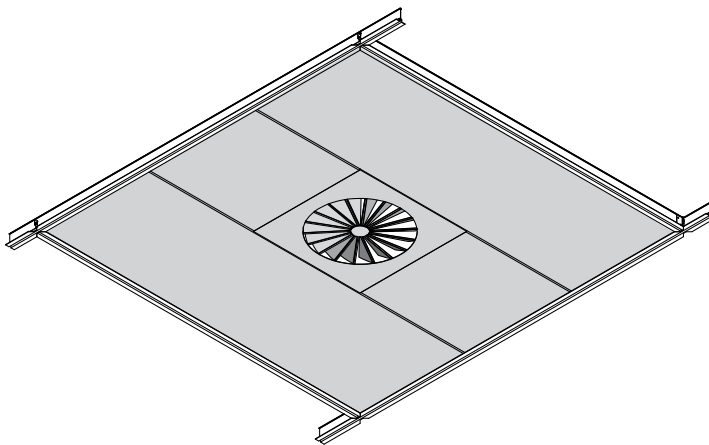

Simple integration of light fixtures and swirl diffusers

## Key Features

- Simplicity of square module, enabling panels and light fixtures to be rotated by 90°
- Robust extruded aluminium "top hat" profile for both primary and secondary sections
- Clean, flush fitting, mitred grid intersections
- Full and rapid demountability and re-use of components
- Complete range of interlocking accessories
- Choice of module size, including 1200x1200, 1350x1350 and 1500x1500
- Custom sizes available
- Simple panel removal and plenum access
- Mechanical services integration, including support tray options. Contact your Armstrong Ceilings office for further details.

Additional information and detailed drawings on the Blue Tongue Modular System can be found at [www.armstrongceilings.com.au](http://www.armstrongceilings.com.au)

# AXIOM Perimeter Solutions and Accessories

## Perimeter / Transition Trims / Wall Angles

Suitable for all Systems

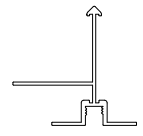
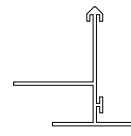
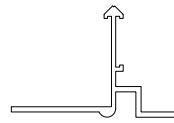
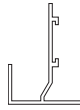
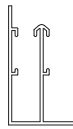
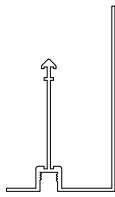

Item No.	ALPT4500LL	ALPTQLFF45	ALBULK3600SW	ALPTPERFTH3600	ALPTFF	ALPT3600PB
Description	Top Hat with 70mm Upturn	Flat Face	Bulk Head Trim	Perforated Top Hat	Flat Face with Horizontal Leg for 13 PB	Top Hat with Horizontal Leg for 13 PB
Dimensions (mm) (l) x (h) x (w)	4500 x 70 x 41	3600 x 45 x 24	3600 x 38 x 28	3600 x 38 x 45.5	3600 x 45 x 32	3600 x 45 x 32

Only suitable for Modular Ceiling Systems

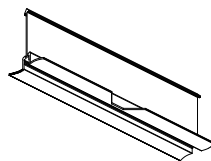

Suitable for all Systems

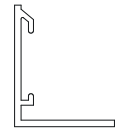
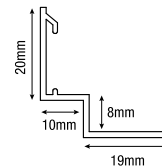

Item No.	ALMRTH3600OS	ALMRTH4050OS	ALMRTH4500OS	AL009RCPSW	AL008RCPSW
Description	Top Hat Punched one side @ 1200cc.	Top Hat Punched one side @ 1350cc.	Top Hat Punched one side @ 1500cc.	Shadow line Suits roll in clip ALRIC	Std "L" Suits roll in clip ALRIC
Dimensions (mm) (l) x (h) x (w)	3600 x 45 x 32	4050 x 45 x 32	4500 x 50 x 32	3600 x 29 x 29	3600 x 24 x 20

## Perimeter Trims / Accessories for One Way MetalWorks Hook On System

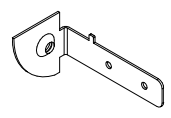
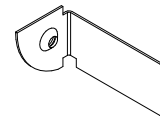
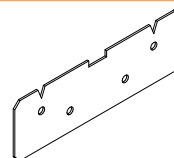
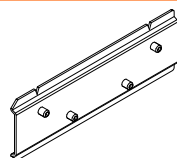
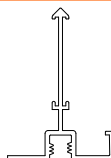

Item No.	ALPTONEWAYSW	ALPTHO	ARM-037	ARM-035	ARM-034	ARM-033
Description / Application	Perimeter Trim	Top Hat Hook On Plasterboard Perimeter	Perimeter Trim Joiner Grub screw fastening	Main Runner Joiner To suit ALOWTHMR	Roll In Clip Connects Main Runner to Perimeter Trim	Roll In Clip Connects Locking Spline to Perimeter Trim
Dimensions (mm)	600 x 50 x 25	3600 x 50 x 35				

## Accessories for Modular, One Way (for Mineral Fibre) and Two Way Systems

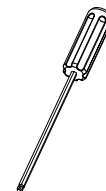
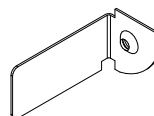
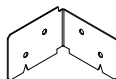
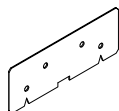
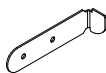

Item No.	ALRIC	ALMRJL*	ALMRJL90	ALRICL	ALSDL / ALSDS	ALSCLH
Description	Roll In Clip Small	Main Bar Joiner	90 Degree Bracket	Roll in Clip Large	ALSDL: Long grub screw-driver ALSDS: Small grub screw-driver	Suspension Clips
Application of Accessory Item	Connects all sections with all wall angles and Perimeter Trims / Pelmet	Connects all Main Bars: 45 and 50mm sections *M/R Joiner for Two Way System is BP9338	Used with all Main Bars 45 and 50mm sections	For connecting Main Bars or Cross Runners to Perimeter Trims	For use with Grub screw Roll in Clip	For use on all Main Bars and Perimeter Trims

# AXIOM Pelmet Systems



3-Sided Pelmet with slotted Air Diffuser Face Plate – Modular Grid and Ultima panel — Woolworths HQ, Sydney

## Transition in style

Regain aesthetic control of the perimeter with an Armstrong® Axiom Pelmet Systems. The transition from pelmet to either plasterboard margin or acoustic ceiling is now simple. Armstrong® Axiom Pelmet Systems are a pre-engineered solution, integrating curtain pelmets, air distribution and ceiling elevation changes. Field fabrication and on-site decisions become a thing of the past. Armstrong® Axiom Pelmet Systems directly integrate with the ceiling grid via a positive locking connection clip. Concealed splice plates enable mechanical lock connections between adjacent pelmet sections.

## Three easy Profiles

There are three basic aluminum extrusion profiles that provide a precise, crisp architectural detail.

1

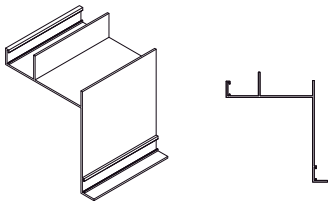

2-Sided Pelmet with transition to Acoustical/Drywall Grid

Single piece aluminium extrusion that forms a simple 2 sided pelmet. Transition to either acoustical grid or set plaster margin.

2

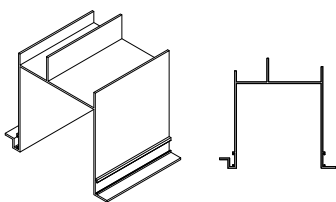

3-Sided Pelmet with transition to Acoustical/Drywall Grid

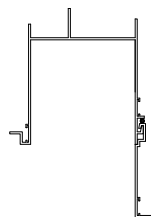

Pelmet with Extension

Pre-engineered aluminium 3 sided pelmets can be produced from one or two piece sections enabling flexibility in size of pelmet. Extension components allow for additional design flexibility and ceiling elevation changes. Transition to either acoustical grid or set plaster margin.

3

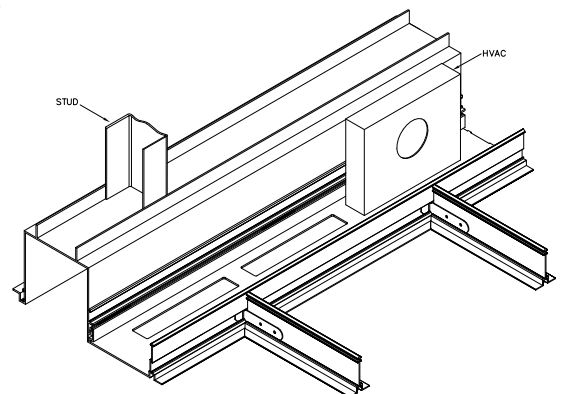

3-Sided Perimeter Pelmet with Diffuser Face Plate and transition to "Blue Tongue" Grid

Pelmets can be designed for full integration with air distribution at the perimeter. Diffuser face plate is pre-slotted according to air supply specifications. Transition to either acoustical grid or set plaster margin.



# AXIOM Pelmet Systems



Three-Sided Pelmet with Air Diffuser Face Plate



Two Piece Pelmet with Margin

## Accessories for Axiom Pelmet Sections

### Component Specifications

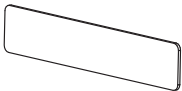

Item	Design
ALMRJS	Joiner for Pelmet



Single Piece Pelmet

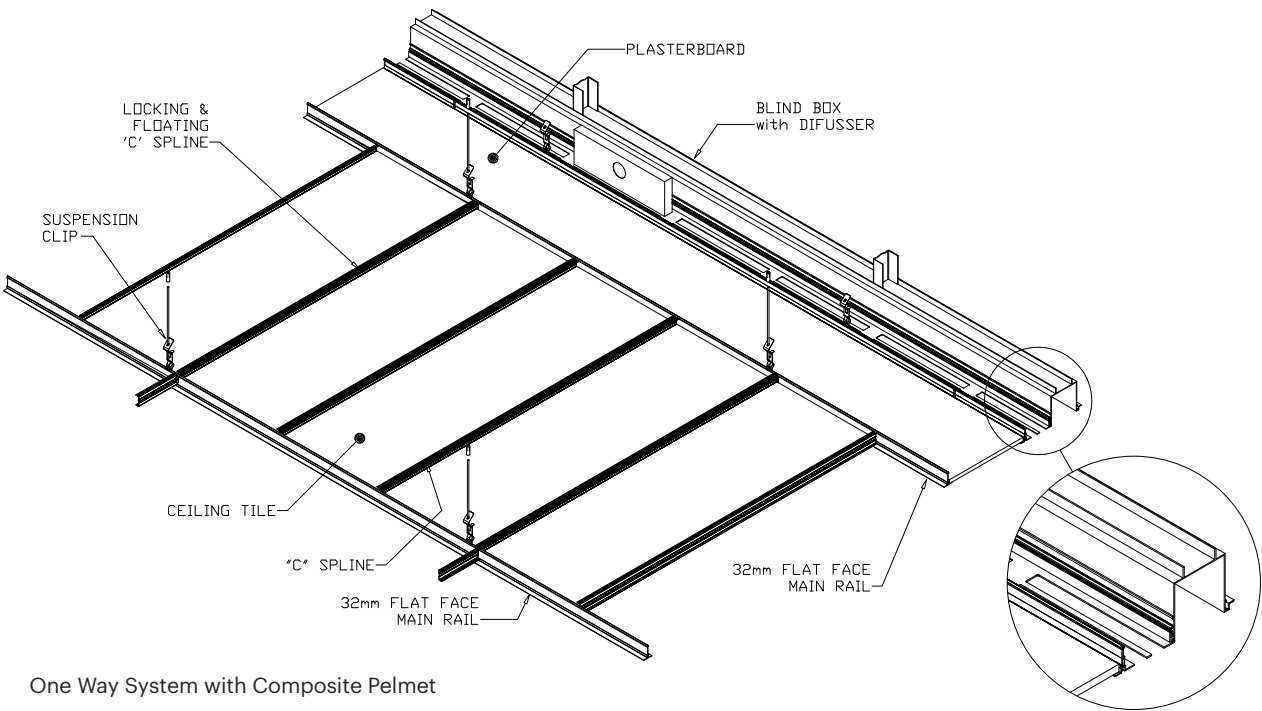

One Way System with Composite Pelmet

Additional information and detailed drawings on the Axiom Pelmet Systems can be found at [www.armstrongceilings.com.au](http://www.armstrongceilings.com.au)





For Seismic Design support please contact your local Armstrong Ceilings office.

## Contact us

### NSW/ACT

Armstrong Ceiling Solutions (Australia) Pty. Ltd.  
Unit 4, 1 Basalt Road, Pemulwuy NSW 2145  
Telephone (02) 9748 1588

### VIC/TAS

Armstrong Ceiling Solutions (Australia) Pty. Ltd.  
Unit 1, 88 Henderson Road, Rowville VIC 3178  
Telephone (03) 8706 4000

### QLD / NT

Armstrong Ceiling Solutions (Australia) Pty. Ltd.  
6 Barrinia Street, Slacks Creek QLD 4127  
Telephone (07) 3809 5565

### SA

Total Building Systems Pty. Ltd.  
160 Grand Junction Road, Blair Athol SA 5084  
Telephone (08) 7325 7555

### WA

Ceiling Manufacturers of Australia Pty. Ltd.  
3 Irvine Street, Bayswater WA 6053  
Telephone (08) 9271 0777

### New Zealand

Forman Building Systems Ltd.  
27B Smales Road, East Tamaki, Auckland 2013  
Telephone 64-9-276 4000

**Armstrong**  
CEILING SOLUTIONS