

Drywall Grid System Technical Guide Wall Systems



Wall Systems

DRYWALL GRID SYSTEM

Drywall Grid Systems

Features and Benefits

Armstrong Drywall Grid is fast and easy to install and an economical alternative to TCR and Furring Channel construction.

Applications

Armstrong Drywall Grid Systems offer flexible design solutions for:

- Flat and Curved Ceilings
- Bulkheads (Multiple Step and Curved)
- Transitions to Acoustical Ceilings
- Margins
- Perimeters
- Walls

Features

- **PeakForm**
Patented profile increases strength and stability for improved performance during installation
- **Knurled Face**
Positive screw penetration into tees
- **SuperLock / XL²**
Main Bar and Cross Runner clips are engineered for a strong secure connection and fast accurate alignment confirmed with an audible click; easy to remove and relocate
- **ScrewStop**
Reverse hem prevents screw spin off on Tee face
- **38mm Wide Face**
Main Bars and Cross Runners – easy installation of screw fixed plasterboard sheets
- **Rotary stitched Double Thickness Web**
For additional torsional strength and stability
- **Simple Integration of Mechanical Services**

Benefits

- Reduced installation time
- Reduced labour costs
- Reduced material costs and wastage
- Low 38mm profile across one plane
- Material off cuts can be used for bracing and as an alternative suspension method

Physical Data

- Material: Hot dipped galvanised steel
- Recycled Content: 25%
- Surface Finish: Z275 galvanised
- Main Bar / Cross Runner Interface: Joggled ends
- End Detail:
 - Main Bar: staked-on SuperLock clip
 - Cross Runner: staked-on XL² clip

Code Compliance

Armstrong DGS is designed and manufactured to comply with the following standards:

AS/NZS 2785-2020: Suspended Ceilings – Design and Installation

AS/NZ 2589-2007: Gypsum linings – Application and finishing

AS/NZ 1397-2002: Steel sheet and strip – Hot-dipped zinc-coated or aluminium/zinc-coated

AS/NZ 4600-2005: Cold-formed steel structures

AS/NZ 1170-2002: Structural Design Actions

Grid Accessories

LEGEND: ● Flat Ceilings, ● Wall systems, ● Curved Ceilings, ● Quikstix Bulkheads, ● ShortSpan

Application

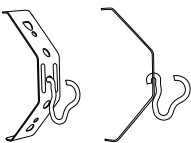
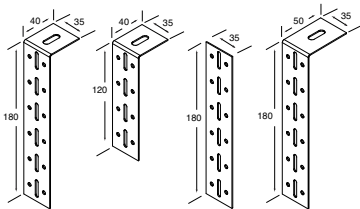
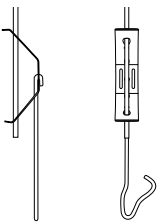
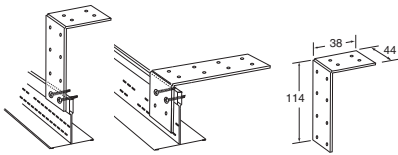
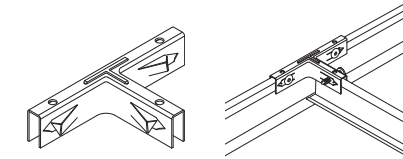
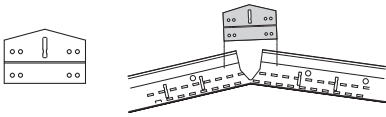
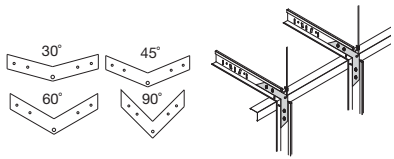
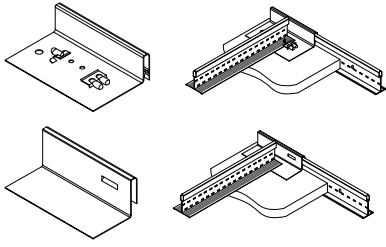

| Item Number | Product Description | Pcs / Bucket | Legend |
|--|---|--------------------------|--|
| BPDW10LT BPDW13LT BPDW16LT ALDW13 | Transition Clips with Locking Tabs facilitate transition from drywall to acoustical ceiling; one-sided hold-down clip; eliminates need for drywall bead. Locking tabs provide secure location for DGS tees For 10mm Plasterboard For 13mm Plasterboard For 16mm Plasterboard Suits 45/50 Top Hat for 13mm Plasterboard | 125 125 125 100 | ● ● ● ● |
| BPDW30C BPDW45C BPDW60C BPDW90C | 30, 45, 60 and 90 degree Drywall Angle Clips are used to create positive and secure angles for drywall and ceiling installations on either Main Bars or Cross Runners | 250 250 250 250 | ● ● ● ● |
| BPRC2 | Radius Clip is used to secure the Main Bar at the desired angle in curved ceiling applications. Includes a rout for Cross Runners installation | 205 | ● |
| BPGC3W | 3 Way Bite Clip connects Intersecting Cross Runners at any point along a Main Bar or other Cross Runners | 250 | ● ● ● |
| BPQSUTC* | Up Tight Clip is used for Direct fix applications *Non stock item – lead time required | 150 | ● ● ● ● ● |
| SCDGS | Rod Hanging Clip is the standard height adjustable suspension clip connecting from 2.5mm or 5mm rod to the DGS Main Bar | 100 | ● ● ● ● |
| DWDFC DWDFC120 DWDFFC180 DWDFC18050 | Direct Fix Clip – 180mm L Shape Direct Fix Clip – 120mm L Shape Direct Fix Clip – 180mm Flat Extension Direct Fix Clip – 180mm L Shape with 50mm Head | 100 100 100 100 | ● |
| DGSSCS | DGS Suspension Clip Small is the standard height adjustable suspension clip connecting from 2.5mm or 5mm rod to the DGS Main Bar | 100 | ● ● ● ● |
| DGSSCTR | DGS Threaded Rod Clip is a suspension clip for 6mm Threaded Rod | 100 | ● ● ● ● |

Wall Systems

Armstrong DGS Wall Systems is a fast and easy solution for framing slim wall profiles and an economical alternative to Furring Channel battening.

Features

- Enables simple framing with fixing points at a maximum span of 1200mm centres.
- Easily self levels saving material and time.
- Enhances quality of finish and speed of construction by virtue of Wall Mouldings at the perimeter.

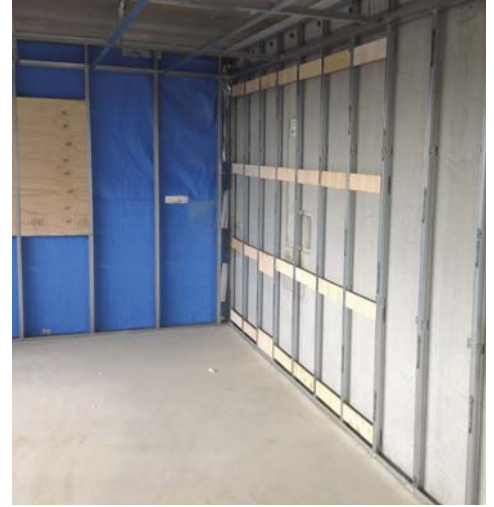

Components

Main Bar: PeakForm 38 with Knurled Face and SuperLock Clip (bulb-to-bulb connection)

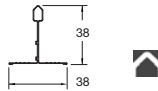
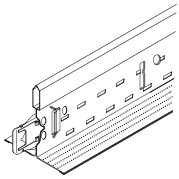

| Item Number | Dimensions | | | Rout Spacing mm | Content / Bundle / Weight | | |
|-------------|-------------|-------------|-----------|--------------------|---------------------------|------|----|
| | length (mm) | height (mm) | face (mm) | | pcs | lm | kg |
| BP 794033 | 3600 | 38 | 38 | 150cc | 12 | 43.2 | 24 |

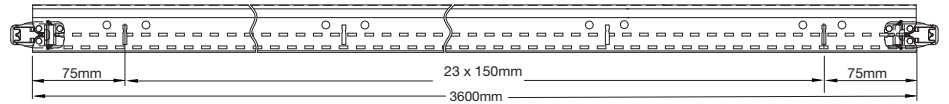

ShortSpan Tee with Knurled Face

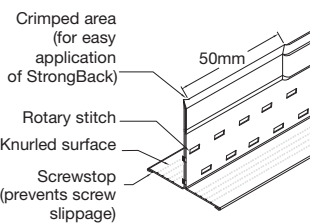

| Item Number | Dimensions | | | Rout Spacing mm | Content / Bundle / Weight | | |
|-------------|-------------|-------------|-----------|--------------------|---------------------------|------|----|
| | length (mm) | height (mm) | face (mm) | | pcs | lm | kg |
| BP 79S36 | 3600 | 38 | 38 | - | 12 | 43.2 | 20 |

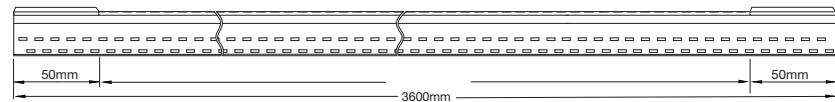

Perimeter Trim

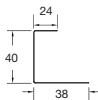
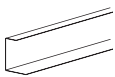

| Item Number | Dimensions | | | Rout Spacing mm | Content / Bundle / Weight | | |
|--|-------------|-------------|-----------|--------------------|---------------------------|------|------|
| | length (mm) | height (mm) | face (mm) | | pcs | lm | kg |
| Knurled Channel Moulding (hemmed with Knurled lower leg) | | | | | | | |
| BP KCM 36 | 3600 | 40 | 38 | - | 12 | 43.2 | 15.6 |

Wall Systems

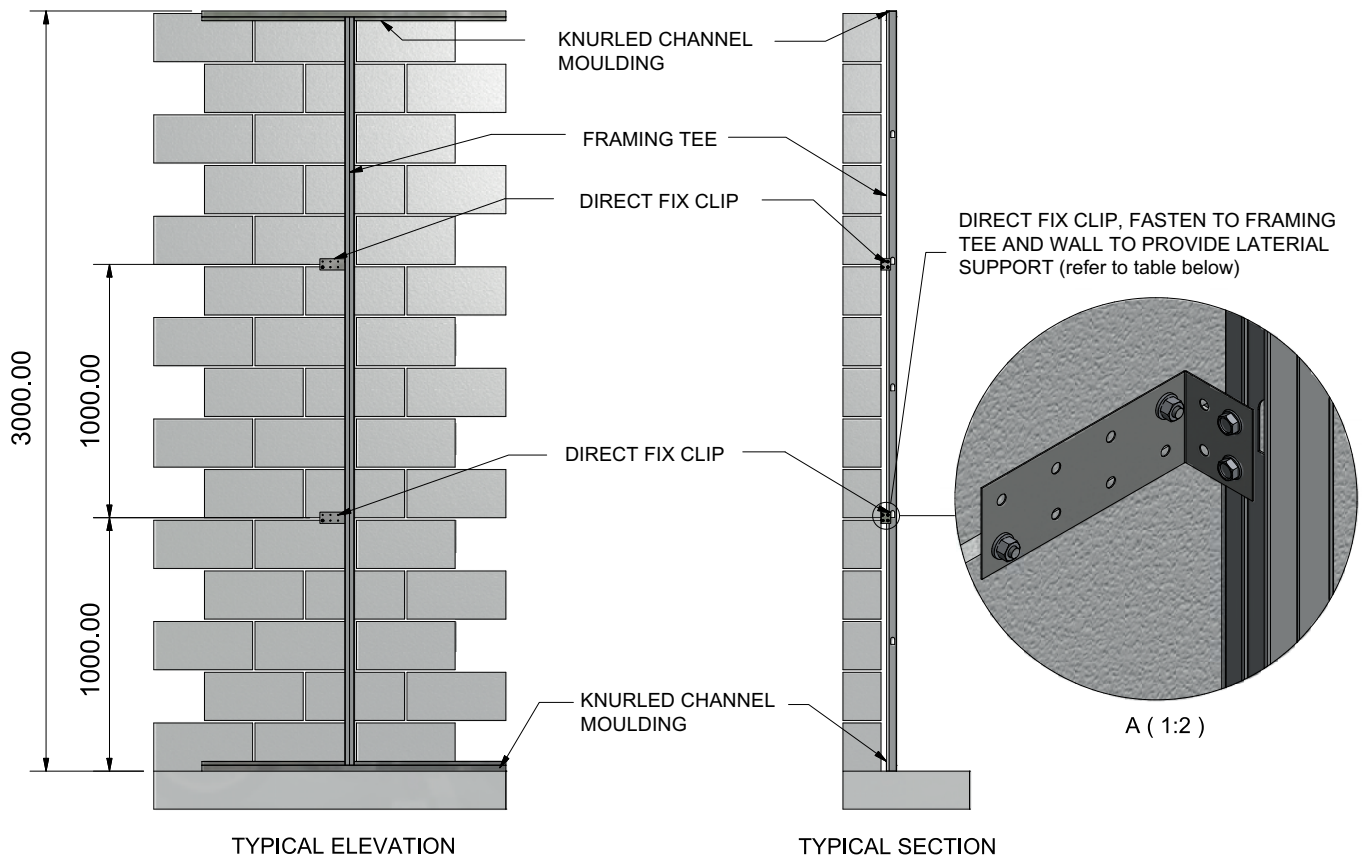

Wall System Clip Spacings

| Main Bar Length | Maximum Anchor Spacing |
|-----------------|------------------------|
| 2400mm | 1200mm centres |
| 2700mm | 900mm centres |
| 3000mm | 1000mm centres |
| 3600mm | 1200mm centres |

Design based on items below

| | |
|----------|------------------|
| BP794033 | 3600mm Main Bar |
| BP79S36 | 3600mm Shortspan |

Installation Guide

The Armstrong Wall System is unique as the primary component is a 38mm Flat Face Tee which can be installed very quickly without requiring any adjustable clips to level your wall.

Step 1. Locate and fix the Channel Moulding top and bottom.

Step 2. Cut the Short Span 38mm Flat Face Main Bars to length and install at required centres (to suit your building board); screw fixing to Chanel Mouldings. This method will aid the wall system leveling.

Step 3. Screw brackets to both the structure (as per Design table), and to the ShortSpan Main Bars.

Locating Insulation

The DGS Wall System allows insulation to be installed easily, and the "Tee Bar" profile holds the insulation in place.

Architectural Specifications

Flat Plasterboard Ceilings: Suspended Grid shall be Armstrong Drywall Grid System, comprising of Main Bars and Cross Runners, including Wall Mouldings and Transition Trims, as per manufacturer's instructions.

Curved Plasterboard Ceilings: Suspended Grid shall be Armstrong Drywall Grid System, comprising of Main Bars (faceted) and Cross Runners, including Wall Mouldings and Transition Trims, as per manufacturer's instructions.

Corridors or Plasterboard Margins: Suspended Grid shall be Armstrong DGS ShortSpan, comprising of ShortSpan Tees and StrongBack Support sections (where required), including Wall Mouldings and Transition Trims as per manufacturer's instructions.

Bulkhead / Soffit: Suspended Grid structure shall be Armstrong DGS QuickStix, comprising of QuickStix Tees and Cross Runners, including Wall Mouldings and Transition Trims, as per manufacturer's instructions.

Wall Battening: Wall framing shall be Armstrong Drywall Grid System, comprising of ShortSpan, or Main Bar, including Knurled Channel mouldings, as per manufacturer's instructions.

Contact your Armstrong Office for additional project specification details.

For Seismic Design support please contact your local Armstrong Ceilings office.

Distributed by



GrayKing Interior Supply

☎ NSW (02) 9666 6688
☎ QLD (07) 3267 6222
✉ sales@grayking.com.au
🌐 grayking.com.au



Madex Linings & Ceiling Distributors

☎ VIC (03) 9336 2419
✉ info@mlcd.com.au
🌐 mlcd.com.au



M & C Plaster Supply

☎ VIC (03) 9362 0214
✉ info@mcplaster.com.au
🌐 mcplastersupplies.com.au