

ECOUSTIC® BAFFLE INSTALLATION INSTRUCTIONS - FELT SCREEN

Baffle extrusions are available in lengths of 2700mm or 1200mm for nominal 12mm + 25mm baffle thicknesses

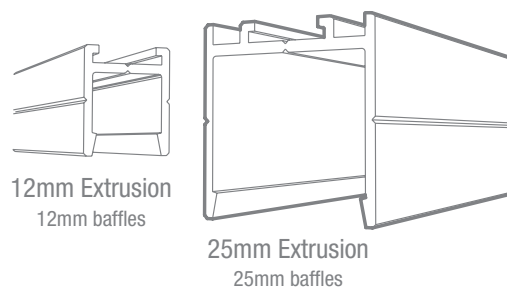
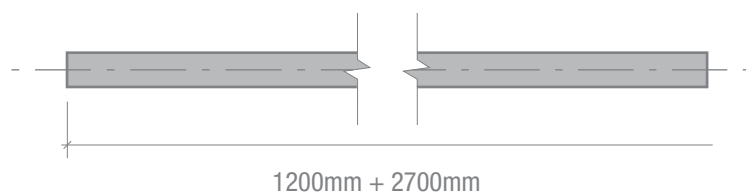

ASSEMBLY OPTIONS - CONNECTING BAFFLE TO EXTRUSION

Weight Rating: Maximum weight rating per baffle extrusion with all hardware options: 20kg

1. Friction Fit + Adhesive

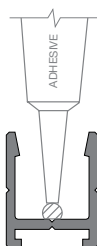

Apply continuous bead of appropriate adhesive to underside of baffle extrusion.

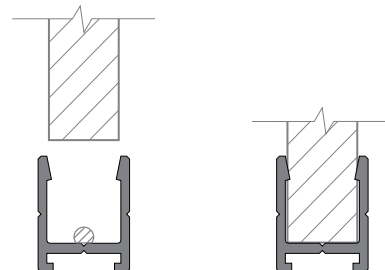

Friction fit the baffle to the extrusion, applying equal pressure along the length of the baffle.

2. Fastener From Side

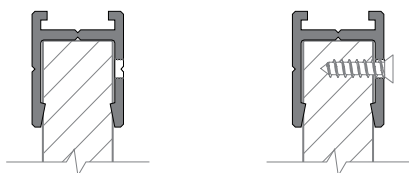

Attach extrusion to baffle and fasten screw through extrusion recess.

3. Fastener From Above

Ecoustic® Felt Screen 25mm

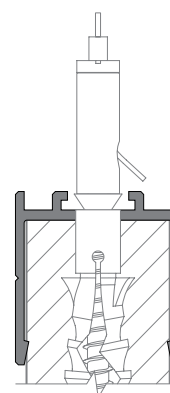

Continued on page 3.

STRUCTURAL ENGINEER'S SAFETY CERTIFICATION IS RECOMMENDED FOR ALL OVERHEAD INSTALLATIONS

CEILING SUSPENSION LOCATION GUIDE - FELT SCREEN

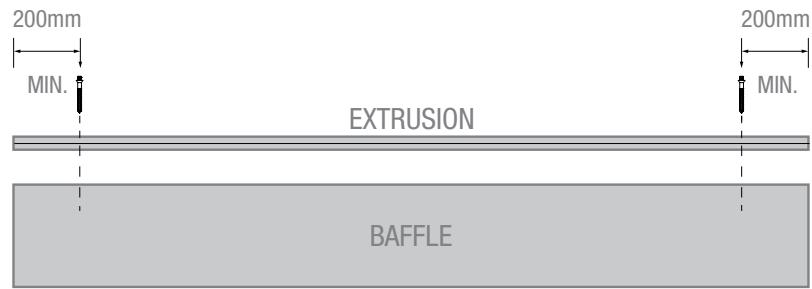

Suspension points should be placed minimum 200mm from either end of the baffle.

For installations using assembly option 3 (Ecoustic® Felt Screen 25mm), plasterboard anchors are required. These are supplied with Ecoustic® Felt Screen 25mm baffles and are also available at any leading hardware store.

Optimal size of anchors are 10mm in diameter (nominal anchor: Ramset RamPlug 10mm x 50mm).

VERTICAL CABLE INSTALLATION OPTIONS - FELT SCREEN

Option A - Ecooustic® Baffle Screw

Ecooustic® Felt Screen 25mm

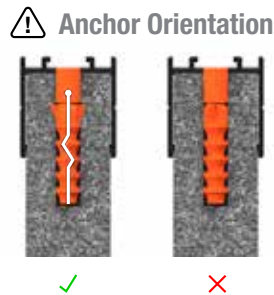
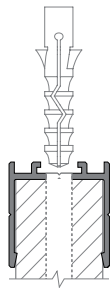

Attach extrusion to baffle and reverse-drill hole for anchor into baffle through pre-drilled holes in extrusion.* Insert the anchor into baffle.

Please Note: Ensure the anchor split line faces the end of the baffle (see diagram above).

Attach cable fixture to exposed screw head before fastening the screw into the anchor.

Push and hold down the cable clutch while threading the cable through to the desired length. Cut any excess cable.

Baffle Compression

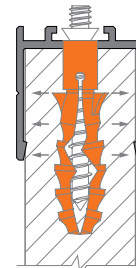
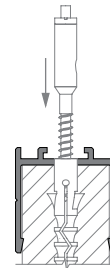

Correct anchor orientation will ensure the baffle substrate is compressed against the extrusion arms and held securely in place when the fastener is inserted.

* Please Note: holes must be 200mm min. from baffle end.

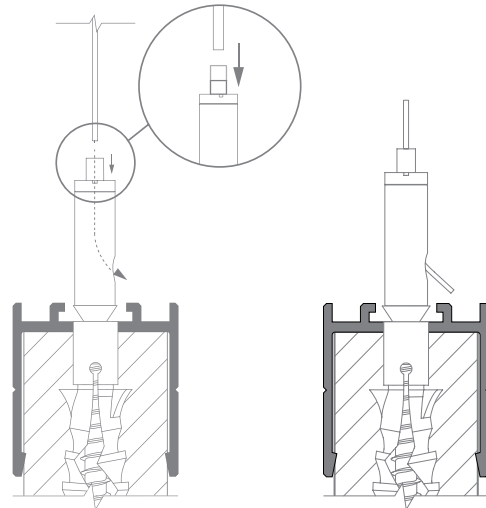

Option B - Sliding Cable Mount Via Extrusion

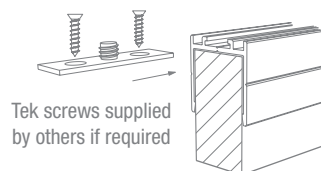

Tek screws supplied by others if required

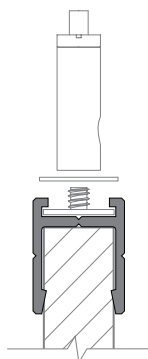

After extrusion is secured to baffle, insert sliding rail into extrusion. Secure cable fixture to exposed screw head with supplied washer between.

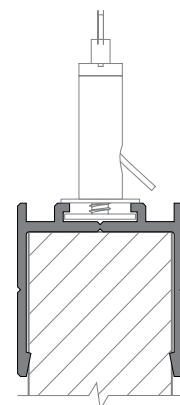
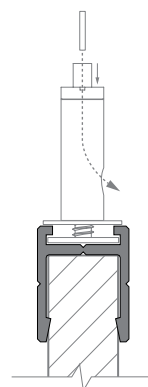

Push and hold down the cable clutch while threading the cable through to the desired length. Cut any excess cable. Same process for 12mm + 25mm baffles. Slide cable clutch and rail to desired baffle location and secure.

SUSPENDED TEE BAR INSTALLATION - FELT SCREEN

Suspended 'Tee' Bar Installation

GRAYKING.COM.AU

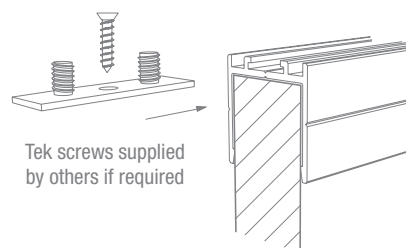
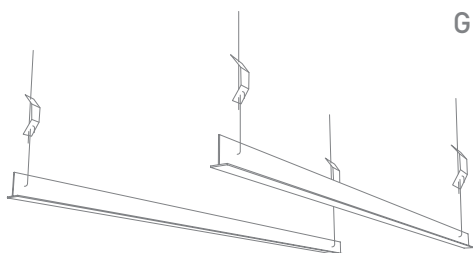

Install 'tee' bars to manufacturer's specification at desired level. Minimum two 'tee' bars per baffle span.

After extrusion is secured to baffle, insert sliding rails into extrusion.

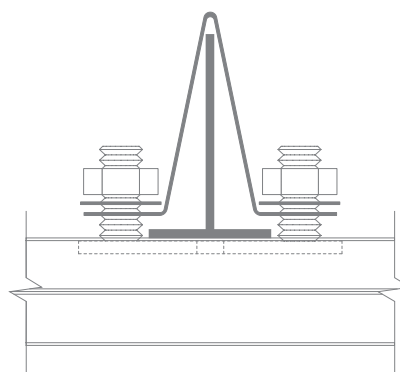
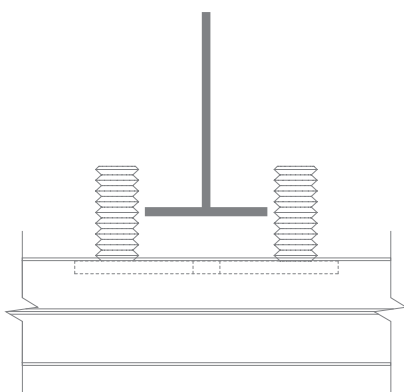

Offer baffle assembly to ceiling 'tee' bar ensuring 'tee' bars are centred between mounting studs.

Place collars over 'tee' bars and mounting studs. Screw hand tighten nuts and washer over mounting studs.

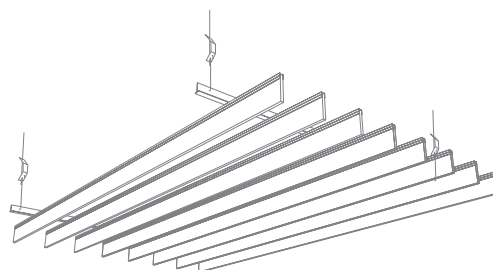
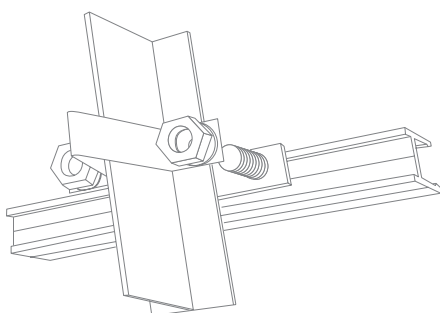

Slide collar and rail along extrusions, and baffle assembly along 'tee' bar to desired location if necessary. Tighten nuts over collar to lock baffle in position.

Completed assembly.

DIRECT FIX INSTALLATION - FELT SCREEN

Direct Fix Installation

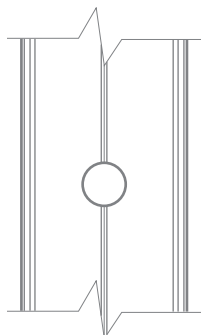

Secure appropriate fasteners into substrate through pre-drilled holes in baffle extrusion.

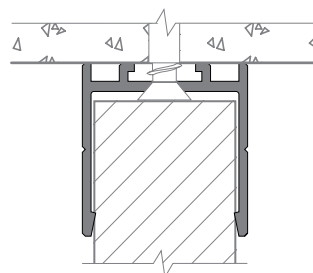
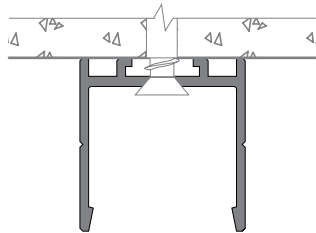

Secure baffles to extrusions using the options outlined on page 1 and 2.

Ceiling + Wall

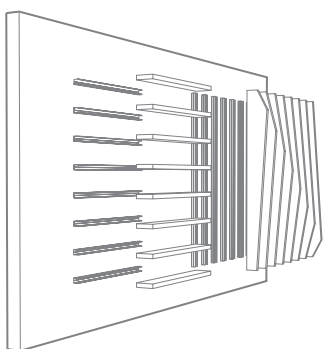

Follow the same procedure above for wall and ceiling installations of baffle.

Column

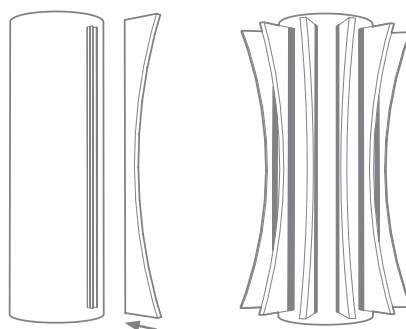

Follow the same procedure above for column installations of baffle.

METAL ROD INSTALLATION - FELT SCREEN

Rod Installation

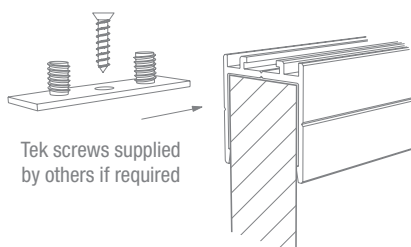

Tek screws supplied
by others if required

After extrusion is secured to baffle, insert sliding rails into extrusion.

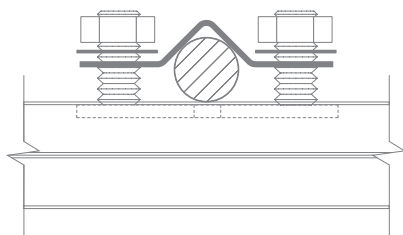

Place collars over rods and mounting studs, screw hand tighten nuts and washers over mounting studs.



Completed assembly.

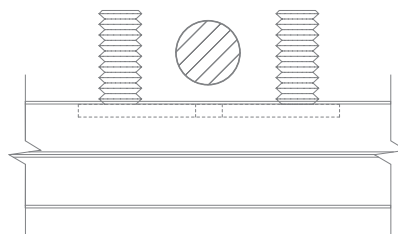

Offer baffle assembly to structural rods ensuring rods are centred between mounting studs. (Minimum 2 rods per baffle span).

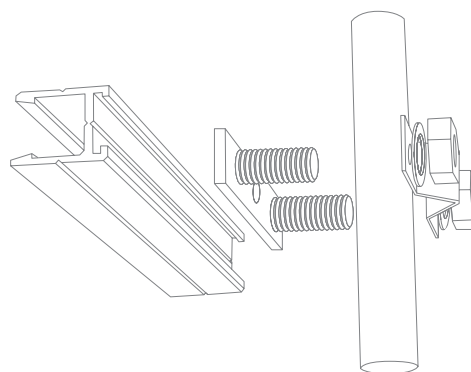

Slide collar and rail along extrusions, and baffle assembly along rods to desired location if necessary. Tighten nuts over collar to lock baffle in position.

SLUNG CABLE SUSPENSION INSTALLATION - FELT SCREEN

Slung Cable Installation

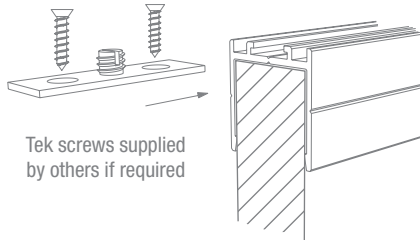

Tek screws supplied
by others if required

After extrusion is secured to baffle, insert sliding rails into extrusion.

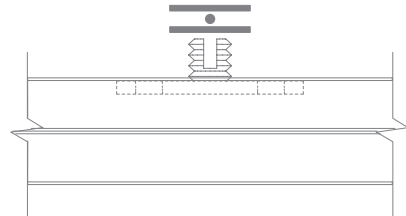

Offer baffle assembly to structural cables ensuring cables are centred within fastener cavity and between washers. (Minimum 2 cables per baffle span).

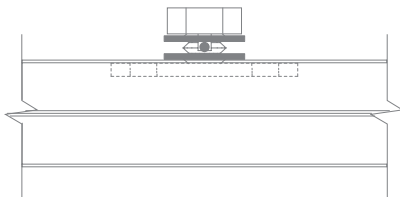

Hand tighten nuts over assembly, capturing the cable between the washers.

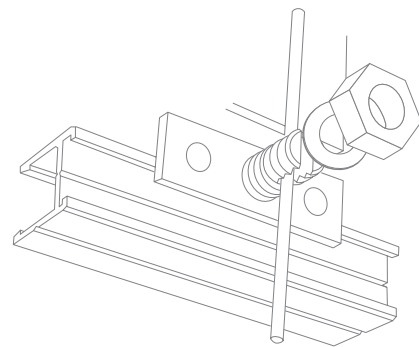

Slide rails along extrusions, and baffle assembly along cables to desired location if necessary. Tighten nuts over washers to lock baffle in position.

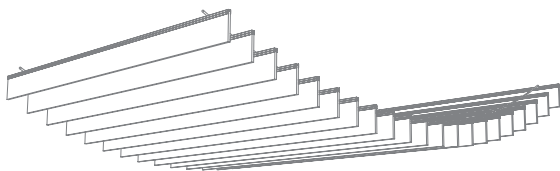

Completed assembly.

COLLAR STRAP INSTALLATION - FELT SCREEN

Ceiling Collar Strap Installation

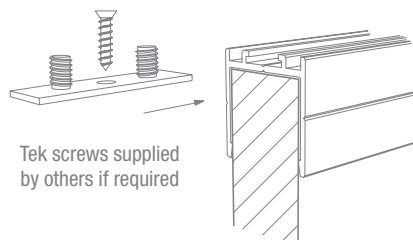

After extrusion is secured to baffle, insert sliding rails into extrusion.

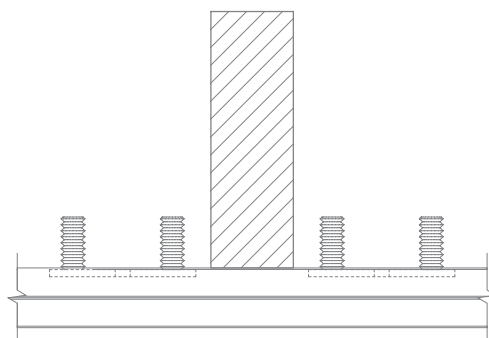

Offer baffle assembly to building structure ensuring it is centred between two sliding rails. (Minimum 2 structural components per baffle span).

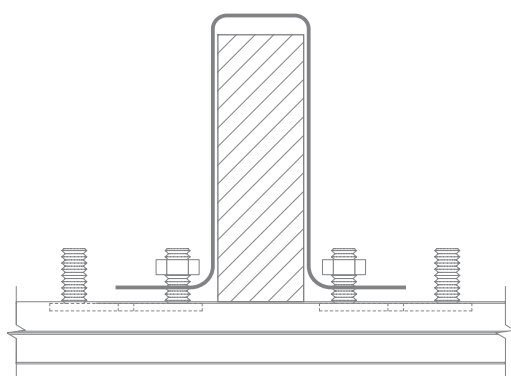

Measure and cut strap to length, place strap over structural components and mounting studs, screw hand tighten nuts and washers over mounting studs.

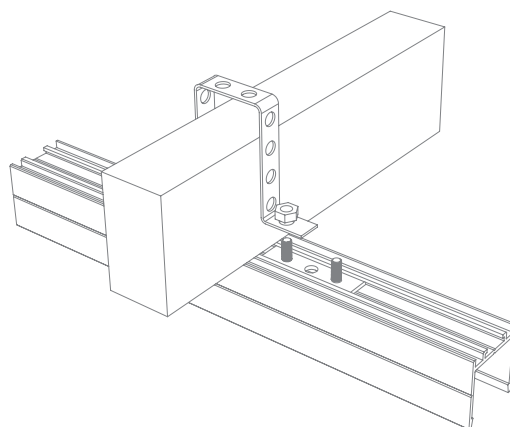

Slide strap and rails along extrusions, and baffle assembly along structural components to desired location if necessary. Tighten nuts over strap to lock baffle in position.

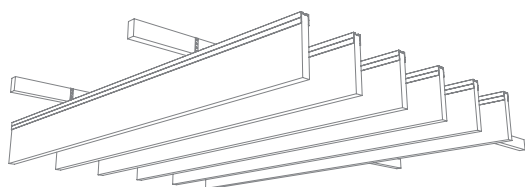

Completed assembly.

CARE - FELT SCREEN BAFFLE

Please Note

- Ecoustic® Baffles should be removed from the ceiling or wall to ensure they can be cleaned safely.
- Disassemble baffle in reverse sequence of the relevant assembly process mentioned above.
- It is recommended to spot clean only by a professional cleaner.

Regular Care

- Protect from direct heat and sunlight.
- To prevent dust build up, lightly dust with a soft cloth or vacuum with a soft brush attachment.

Spot Cleaning

- Professional cleaning is always recommended.
- Always test any cleaning products on an inconspicuous area prior to commencing cleaning.
- Blot any excess spills from the material with a dry clean sponge or cloth.
- Treat all stains and spills as soon as possible.
- Most marks can be spot cleaned by lightly wetting the affected area with a mild detergent and warm water solution.
- Do not saturate the baffle panel.
- Do not scrub or abrade the fabric as this will affect the surface finish.
- Once the stain or mark has been loosened then blot the excess solution out with a dry clean cloth.
- Sponge afterwards with clean warm water and mop any excess moisture with a dry clean sponge or cloth.
- The surface can also be spot cleaned with dry cleaning fluid. Lightly sponge a small amount of dry cleaning fluid and blot.
- Dry away from direct heat and sunlight.
- Avoid the use carpet shampoos.

Distributed by



**Grayking Interior
Supply Pty Ltd**

NSW

📍 65A Stephen Road
Botany New South Wales 2019

☎ (02) 9666 6688
✉ sales@grayking.com.au

QLD

☎ (07) 3267 6222
✉ sales@grayking.com.au

GRAYKING.COM.AU

INSTYLE